



IMMACULATA
UNIVERSITY

COLLEGE OF GRADUATE STUDIES

COURSE LISTING SUMMER 2023

May 15, 2023–August 17, 2023

ABOUT THE COLLEGE OF GRADUATE STUDIES

IMPORTANT DATES

**Monday,
March 20, 2023 | 6:00 a.m.**
Online registration begins.

Directions for registering online
can be found on pages 10-12.

**Monday,
May 15, 2023**
Summer 2023
Semester begins.

Dear Students:

We are pleased to invite new, continuing and prospective students to preview the summer 2023 College of Graduate Studies Course Listing.

Immaculata University offers master's, doctoral and certification programs in the areas of education, psychology, health care and business. All of our programs are rooted in academic rigor, ethical integrity, and Christian core values and encourage a commitment to lifelong learning and professional excellence. Students are supported by an engaged and professional faculty who create opportunities for growth through teaching-learning relationships, research and service.

To meet student needs, graduate courses are offered in face-to-face, online and hybrid formats. The course listing is arranged by department and provides specific details for each course offering. Course descriptions can be found in the Graduate Catalog available on the website at immaculata.edu/graduate.

New and current students needing assistance with registration may contact the Graduate Office at 484-323-3211 or graduate@immaculata.edu.

There is still time for prospective master's-level students to apply for the summer semester. Apply online at immaculata.edu/gradapply or contact Sandra Rollison, Associate Dean, at 484-323-3215 or srollison@immaculata.edu.

Wherever you are in your academic journey, we are dedicated to helping you achieve your academic and professional goals!

Sincerely,



Dr. Marcia Parris
Dean, College of Graduate Studies

CLASS MEETING DATES SUMMER 2023

SUMMER I: May 15, 2023–July 3, 2023

MONDAY	TUESDAY	WEDNESDAY	THURSDAY
May 15	May 16	May 17	May 18
May 22	May 23	May 24	May 25
May 29 - OFF	May 30	May 31	Jun 1
Jun 5	Jun 6	Jun 7	Jun 8
Jun 12	Jun 13	Jun 14	Jun 15
Jun 19 - OFF	Jun 20	Jun 21	Jun 22
Jun 26			
Jul 3			

SUMMER II: July 5, 2023–August 17, 2023

MONDAY	TUESDAY	WEDNESDAY	THURSDAY
	Jul 4 - OFF	Jul 5	Jul 6
Jul 10	Jul 11	Jul 12	Jul 13
Jul 17	Jul 18	Jul 19	Jul 20
Jul 24	Jul 25	Jul 26	Jul 27
Jul 31	Aug 1	Aug 2	Aug 3
Aug 7	Aug 8	Aug 9	Aug 10
Aug 14	Aug 15		

SUMMER FULL: May 15, 2023–August 17, 2023

MONDAY	TUESDAY	WEDNESDAY	THURSDAY
May 15	May 16	May 17	May 18
May 22	May 23	May 24	May 25
May 29 - OFF	May 30	May 31	Jun 1
Jun 5	Jun 6	Jun 7	Jun 8
Jun 12	Jun 13	Jun 14	Jun 15
Jun 19 - OFF	Jun 20	Jun 21	Jun 22
Jun 26	Jun 27	Jun 28	Jun 29
Jul 3	Jul 4 - OFF	Jul 5	Jul 6
Jul 10	Jul 11	Jul 12	Jul 13
Jul 17	Jul 18	Jul 19	Jul 20
Jul 24	Jul 25	Jul 26	Jul 27
Jul 31	Aug 1	Aug 2	Aug 3
Aug 7	Aug 8	Aug 9	Aug 10
Aug 14	Aug 15		

NOTE: Certain graduate classes follow an alternate calendar. Please check courses carefully for meeting dates.

Immaculata University is committed to the principle of equal educational opportunity without unlawful discrimination because of an applicant's or student's race, gender, ethnicity, religion, age, national origin, color, disability, marital status, familial status, veteran status, ancestry, genetic characteristics, pregnancy, or other classifications protected by law or University policy.

GRADUATE COURSE LISTING

SUMMER 2023

COURSE SCHEDULE | May 15, 2023–August 17, 2023

CRN	COURSE NO.	COURSE NAME	CR	DAY/TIME	LOCATION	INSTRUCTOR
CORE/GENERAL PROGRAM SUPPORT COURSES - Dr. Marcia Parris, Dean						
50213	GEN 501A	A Human Development (5/15–7/5)	3	Log into Moodle M 5/15 by 10:00 p.m.	Online	Dr. Toe Aung
50214	GEN 501B	Human Development (7/6–8/17)	3	Log into Moodle Th 7/6 by 10:00 p.m.	Online	Dr. Dane Aucker
50210	GEN 502A	Methods of Research (5/15–7/5)	3	Log into Moodle M 5/15 by 10:00 p.m.	Online	Dr. Kathy Soeder
50211	GEN 502B	Methods of Research (5/18–8/10)	3	Log into Moodle Th 5/18 by 10:00 p.m.	Online	Dr. Kathy Soeder
50212	GEN 503A	Interpersonal Relations (5/15–7/5)	3	Log into Moodle M 5/15 by 10:00 p.m.	Online	Staff
50215	GEN 503B	Interpersonal Relations (7/6–8/17)	3	Log into Moodle Th 7/6 by 10:00 p.m.	Online	Staff

ATHLETIC TRAINING - Dr. Kelly Stalker, Director						
50133	ATP 501	Foundations in Athletic Training (hybrid)	3	FF: M 8/7, 1:30 - 4:30 pm; T/8/8, 1:00–4:00 p.m.; Th 8/10, 9:00–10:30 a.m. Online 7/5–8/6	AH 115	Staff
50134	ATP 503	Structional & Functional Kinesiology (hybrid)	3	FF: M 8/7, 9:00 a.m.–12:30 p.m.; T/8/8, 9:00 a.m.–12:00 p.m.; Th 8/10, 11:00 a.m.–12:30 p.m. Online 7/5–8/6	PS 113	Dr. Kelly Stalker
50135	ATP 504	Emergency Medical Care	4	FF: W 8/9, 9:00 a.m.–4:00 p.m.; Th 8/10, 1:30–3:30 p.m. Online 7/5–8/6	AH 115	Staff
50128	ATP 507	Head and Spine Assessment (5/15–7/3)	3	One face to face meeting TBD	Online	Staff
50130	ATP 510	General Medical Conditions (5/15–8/17)	3	Two face to face meetings TBD	Online	Staff
50131	ATP 512	Mental Health Strategies	3	Online 7/5–8/17	Online	Staff
50129	ATP 553	Clinical III	2	Online 5/15–7/3	Online	Dr. Michele Monaco
50132	ATP 556	General Medical Clinical	1	Online 7/5–8/17	Online	Staff

EDUCATIONAL LEADERSHIP - Dr. Karen Miscavage, Director						
50162	EDL 599	Comprehensive Examination	0	Due Monday, July 17	Online	Dr. Karen Miscavage
50163	EDL 615	Contemporary Professional Ethics (online 7/3–8/14)	3	Log into Moodle M 7/3 by 10:00 p.m.	Online	Dr. Thomas O'Brien
50173	EDL 621	Administration (7/10–7/13)	3	M - Th 9:00 a.m.–5:00 p.m.	LH 116	Dr. Joseph Corabi
50174	EDL 622	Curriculum and Instruction (7/17–7/20)	3	M - Th 9:00 a.m.–5:00 p.m.	LH 116	Dr. Joseph Corabi
50175	EDL 623	Supervision (7/10–7/13)	3	M - Th 9:00 a.m.–5:00 p.m.	LH 216	Dr. Robert Pleis
50176	EDL 625	School Law and Legal Process (7/24–7/27)	3	M - Th 9:00 a.m.–5:00 p.m.	LH 116	Dr. Steven Catambone
50164	EDL 626	School Community Relations (online 5/15–6/26)	3	Log into Moodle M 5/15 by 10:00 p.m.	Online	Dr. Melissa Reed

GRADUATE COURSE LISTING SUMMER 2023

50165	EDL 629	Introduction to Special Education (online 5/15–6/26)	3	Log into Moodle M 5/15 by 10:00 p.m.	Online	Dr. Laura Eisemann
50166	EDL 640	Instructional Accommodations (online 5/15–6/26)	3	Log into Moodle M 5/15 by 10:00 p.m.	Online	Dr. Karen Miscavage
50167	EDL 644	Language Arts Methods (online 7/3–8/14)	3	Log into Moodle M 7/3 by 10:00 p.m.	Online	Dr. Kelly Doyle
50168	EDL 653	Low Incidence Disabilities (hybrid)	3	Th 4:30–8:30 p.m. FF: 6/29; 7/13, 27; 8/10. Online 6/6, 27; 8/3	LH 221	Dr. Karen Miscavage
50169	EDL 661	Literacy in Education (online 5/15–6/26)	3	Log into Moodle M 5/15 by 10:00 p.m.	Online	Dr. Kelly Doyle
50170	EDL 662	Instructional Strategies for Standards Aligned Curriculum (online 7/3–8/14)	3	Log into Moodle M 7/3 by 10:00 p.m.	Online	Dr. Melissa Sica (Bream)
50171	EDL 674	Prevention and Intervention for At-Risk Youth PK-12 (online 5/15–6/26)	3	Log into Moodle M 5/15 by 10:00 p.m.	Online	Dr. Kristina Szobocsan
50172	EDL 675	Mental Health Literacy to Promote Positive Behavior PK-12 (online 7/3–8/14)	3	Log into Moodle M 7/3 by 10:00 p.m.	Online	Staff

DOCTOR OF EDUCATION-K12-LEADERSHIP - Sr. Carol Anne Couchara, Director

50177	EDL 723A	School Business Management	3	Th 5:00–9:00 p.m. (5/18–6/29); Virtual I Cohort Only	Online Synchronous	Dr. Jason Bottiglieri
50178	EDL 723B	School Business Management	3	W 5:00–9:00 p.m. (7/5–8/16)	Online Synchronous	Dr. Joseph O'Brien
50179	EDL 724A	Organizational Development & Change Theory	3	W 5:00–9:00 p.m. (5/17–6/28)	Online Synchronous	Dr. Joseph Corabi
50180	EDL 724B	Organizational Development & Change Theory	3	Th 5:00–9:00 p.m. (7/6–8/17); Virtual I Cohort Only	Online Synchronous	Dr. Joseph Corabi
50181	EDL 726A	Political, Social, Economic Structures of the Culture	3	T 5:00–9:00 p.m. (5/16–6/27); Virtual II Cohort Only	Online Synchronous	Dr. Karen Miscavage
50182	EDL 726B	Political, Social, Economic Structures of the Culture	3	T 5:00–9:00 p.m. (7/11–8/15); Virtual II Cohort Only	Online Synchronous	Dr. Karen Miscavage
50184	EDL 730A	Pupil Personnel Services	3	T 5:00–9:00 p.m. (5/16–6/27); Virtual II Cohort Only	Online Synchronous	Dr. Casey Molitor
50183	EDL 730B	Pupil Personnel Services	3	T 5:00–9:00 p.m. (7/11–8/15); Virtual II Cohort Only	Online Synchronous	Dr. Casey Molitor
50185	EDL 734	Dissertation Research Seminar (5/18–8/10)	3	Th 5:00–9:00 p.m., class meeting dates TBA	Online Synchronous	Staff
50187	EDL 735	The Superintendency	3	M 5:00–9:00 p.m., 5/15, 22; 6/5, 12, 26	Online Synchronous	Dr. Robert Pleis
	EDL 798	Dissertation I	3	By arrangement with Dissertation Chair		
	EDL 799	Dissertation II	3	By arrangement with Dissertation Chair		
	EDL 800	Dissertation III	3	By arrangement with Dissertation Chair		
	EDL 000	Dissertation Continuation	0	Open only to students having completed EDL 798, 799 & 800. Fee equivalent to one doctoral credit: \$955 (first enrollment). Fee equivalent to three doctoral credits: \$2,865 (subsequent enrollment).		

Dissertation students will receive their CNR via Immaculata email.

GRADUATE COURSE LISTING SUMMER 2023

HIGHER EDUCATION - Sr. Ann Heath, Director

50122	HED 632	Assessment of Student Learning Outcomes (5/15–6/16)	3	W 6:00–9:30 p.m. Synchronous meetings 5/17, 5/31; 6/14	Online	Dr. David Parkyn
-------	---------	---	---	--	--------	------------------

DOCTOR OF EDUCATION-HIGHER EDUCATION - Sr. Ann Heath, Director

50121	HED 732	Assessment of Student Learning Outcomes (5/15–6/16)	3	W 6:00–9:30 p.m. Synchronous meetings 5/17, 5/31; 6/14	Online	Dr. David Parkyn
50125	HED 748	Enrollment Management	3	TBD	Online	Staff
50123	HED 772	Learning Theory & Practice for Classroom & Clinical Nursing Education (online 5/15–6/16)	3	Orientation: by arrangement. Synchronous meetings 5/15, 29; 6/12	Online	Dr. Maria Toth
50124	HED 773	Advanced Scientific Inquiry in Nursing & Healthcare (7/5–8/7)	3	W 6:00–9:30 p.m. Orientation: 6/26, Synchronous meetings 7/10, 24; 8/7	Online	Dr. Mary Powell
	HED 820	Applied Field Experience	3	By arrangement with Director		
	HED 798	Dissertation I	3	By arrangement with Dissertation Chair		
	HED 799	Dissertation II	3	By arrangement with Dissertation Chair		
	HED 800	Dissertation III	3	By arrangement with Dissertation Chair		
	HED 000	Dissertation Continuation	0	Open only to students have completed HED 798, 799 & 800. Fee equivalent to one doctoral credit: \$955 (first enrollment). Fee equivalent to three doctoral credits: \$2865 (subsequent enrollments)		

Dissertation students will receive their CNR via Immaculata email.

HEALTHCARE MANAGEMENT - Dr. Anne Marie McCauley, Director

50117	MHCM 610	Health Economics (5/15–7/3)	3	Log into Moodle M 5/15 by 10:00 p.m.	Online	Michelle Green, MBA
50118	MHCM 612	Risk Management and Patient Affairs (7/5–8/9)	3	Log into Moodle W 7/5 by 10:00 p.m.	Online	Dr. Anne Marie McCauley

MANAGEMENT AND LEADERSHIP - Dr. James Siburt, Director

50119	LDR 603	Organizational Ethics (5/17–6/21)	3	W 6:00–8:00 p.m.	Online Synchronous	Dr. James Siburt
50120	LDR 605	Politics of Leading (7/5–8/9)	3	W 6:00–8:00 p.m.	Online Synchronous	Dr. Joshua Weikart

MUSIC THERAPY - Corey Oliver, MA, MT-BC, LPC, Director

50136	MUT 504	Theories & Processes in Medical Music Therapy (5/16–8/17)	3	FF: 6/23, 24, 25; 7/29, 30 9:00 a.m.–4:00 p.m.	VM 208	
50137	MUT 506	Theories & Processes in Psychiatric Music Therapy (5/16–8/17)	3	FF: 5/20, 21, 22; 6/25, 25 9:00 a.m.–4:00 p.m.	VM 208	
50138	MUT 512	Clinical Training I - Integrating Theory and Practice	1	T 4:30–5:20 p.m.	VM 208	Daniel Benonis, MA, MT-BC
50139	MUT 513	Clinical Training II - Integrating Theory and Practice	1	T 4:30–5:20 p.m.	VM 208	Daniel Benonis, MA, MT-BC
50140	MUT 514	Clinical Training III - Integrating Theory and Practice	1	T 5:30–6:20 p.m.	VM 208	Daniel Benonis, MA, MT-BC

GRADUATE COURSE LISTING SUMMER 2023

PART-TIME*						
50141	MUT 521	Graduate Internship I	2	T 7:30–8:30 p.m.	Online Synchronous	Daniel Benonis, MA, MT-BC
50142	MUT 522	Graduate Internship II	2	T 7:30–8:30 p.m.	Online Synchronous	Daniel Benonis, MA, MT-BC
50143	MUT 523	Graduate Internship III	2	T 7:30–8:30 p.m.	Online Synchronous	Daniel Benonis, MA, MT-BC
FULL-TIME*						
50144	MUT 524	Graduate Internship I	2	T 7:30–8:30 p.m.	Online Synchronous	Daniel Benonis, MA, MT-BC
50145	MUT 525	Graduate Internship II	2	T 7:30–8:30 p.m.	Online Synchronous	Daniel Benonis, MA, MT-BC
*Seminars include both on-campus and conference call meetings. Additional Meetings may be arranged. Schedule and location of on-site clinical training to be arranged. Contact Corey Olver at colver@immaculata.edu.						
50146	MUT 530	Music Skills for Therapy - Piano	1	By arrangement	FC T1	Mib Campbell
50147	MUT 530	Music Skills for Therapy - Piano	1	By arrangement		Laurie Schrecengost
50148	MUT 530	Music Skills for Therapy - Piano	1	By arrangement		Meghan Brown
50149	MUT 532	Music Skills for Therapy - Guitar	1	By arrangement		Dr. Bryan Muller
50150	MUT 534	Music Skills for Therapy - Voice	1	By arrangement		Kara Kirsten
50151	MUT 599	Comprehensive Examination	0	Return no later than Monday, June 26 to the Graduate Office		Corey Olver, MA, MT-BC
50152	MUT 606	Songs in Psychotherapy	2	TBD		Christopher Igidbashian
50153	MUT 610	Advanced Music Therapy Practicum	1	M 8:00–9:00 p.m.	Online Synchronous	Corey Olver, MA, MT-BC
50154	MUT 621	Advanced Music Therapy Internship I	1	M 8:00–9:00 p.m.	Online Synchronous	Corey Olver, MA, MT-BC
50155	MUT 622	Advanced Music Therapy Internship II	1	M 8:00–9:00 p.m.	Online Synchronous	Corey Olver, MA, MT-BC
50156	MUT 630	Advanced Music Therapy Skills	1	By arrangement		Corey Olver, MA, MT-BC
50157	MUT 652A	Research Colloquium	1	By arrangement		Corey Olver, MA, MT-BC
50158	MUT 652B	Research Colloquium	1	By arrangement		Daniel Benonis, MA, MT-BC
50159	MUT 690A	Culminating Project in Music Therapy	3	By arrangement		Corey Olver, MA, MT-BC
50160	MUT 690B	Culminating Project in Music Therapy	3	By arrangement		Daniel Benonis, MA, MT-BC
50161	MUT 690C	Culminating Project in Music Therapy	3	By arrangement		Christopher Igidbashian

NURSING - Dr. Pamela Hudson, Director

50114	NURS 655	Nursing Research	3	Log into Moodle M 5/15 by 10:00 p.m.	Online	Dr Carole Lorup
-------	----------	------------------	---	--------------------------------------	--------	-----------------

NUTRITION - Dr. Qian Jia, Director

50116	NED 659	Preparation for Internship	3	TBD		Dr. Danielle Kronmuller
50115	NED 664	Internship Experience in Nutrition III	3	TBD		Dr. Danielle Kronmuller

GRADUATE COURSE LISTING SUMMER 2023

CLINICAL MENTAL HEALTH COUNSELING - Dr. David Martinson, Chair						
50204	COUN 511A	Topics in Psychology: Behavioral Addictions	3	Th 7:20–10:00 p.m.	GC 20	Jane Brown, MA
50207	COUN 511B	Topics in Psychology: Psychopharmacology (5/15–6/21)	3	M, W 7:20–10:00 p.m.; Monday Synchronous, Wednesday, Asynchronous	Online	Dr. Joshua Baker
50209	COUN 511C	Topics in Psychology: Play Therapy (5/15–5/19)	3	M-F 9:00 a.m.–4:00 p.m.	GC 21	Dr. Kristy Brumfield
50208	COUN 511D	Topics in Psychology: Trauma and Addiction	1	F 6/2 4:00–9:00 p.m., Sa 6/3 8:00 a.m.–5:00 p.m.	Online	Jane Brown, MA
50205	COUN 511E	Topics in Psychology: Introduction to Telamental Health	1	F 6/9 4:00–9:00 p.m., Sa 6/10 8:00 a.m.–5:00 p.m.	Online	Jen Urbine, MA
50206	COUN 511F	Topics in Psychology: Proactive Grief Counseling	1	F 7/7 4:00–9:00 p.m., Sa 7/8 8:00 a.m.–5:00 p.m.	GC 20	Jen Urbine, MA
50188	COUN 599	Comprehensive Examination	0	Log into Moodle on first day of semester.	Online	Dr. David Martinson
50189	COUN 600	Research and Program Evaluation (5/17–6/22)	3	W, TH 4:30–7:10 p.m.	GC 1	Dr. David Hunt
50190	COUN 601	Counseling Skills & Techniques 5/16–6/21)	3	T, W 7:20–10:00 p.m.	GC 1	Dr. Kathryn deVries
50191	COUN 602	Theories of Counseling (5/22–5/26)	3	M-F 9:00 a.m.–4:00 p.m.	GC 1	Dr. Kathryn deVries
50192	COUN 604	Group Process (5/15–8/14)	3	M 7:20–10:00 p.m.	GC 20	Dr. Jill Schott
50193	COUN 606	Family Counseling (7/5–8/10)	3	W, TH 4:30–7:10 p.m.	GC 1	Dr. David Martinson
50194	COUN 608	Psychopathology (5/18–8/10)	3	Th 4:30–7:10 p.m.	GC 6	Shelby Krupka, MA
50195	COUN 609	Career and Vocational Counseling (5/17–6/22)	3	W, TH 7:20–10:00 p.m.	GC 21	Dr. David Hunt
50196	COUN 614	Substance Abuse Education & Counseling (5/18–8/10)	3	Th 4:30–7:10 p.m.	GC 21	Jane Brown, MA
50197	COUN 618	Professional Orientation & Ethical Issues (5/15–8/14)	3	M 7:20–10:00 p.m.	GC 21	Angel Myers, MA
50198	COUN 630	Crisis Intervention and Trauma (7/5–8/10)	3	W, TH 7:20–10:00 p.m.	GC 21	Dr. David Martinson
50199	COUN 640	Diversity Counseling (5/15–8/14)	3	Log into Moodle on M 5/15 by 10:00 p.m.	Online	Dr. Kristy Brumfield
50200	COUN 641	Assessment for Counselors (5/16–8/15)	3	Log into Moodle on T 5/16 by 10:00 p.m.	Online	Dr. Kristy Brumfield
50201	COUN 691	Practicum in Clinical Mental Health Counseling	3	M 4:30–7:10 p.m.	GC 1	Seminar Faculty
50202	COUN 692	Internship I in Clinical Mental Health Counseling	3	M 4:30–7:10 p.m.	GC 2	Seminar Faculty
50203	COUN 693	Internship II in Clinical Mental Health Counseling	3	M 4:30–7:10 p.m.	GC 20	Seminar Faculty
50216	PSYC 610	Children with Exceptional Needs (7/5–8/10)	3	Log into Moodle on W 7/5 by 10:00 p.m.	Online	Dr. Tammy Campli
50217	PSYC 655	School Consultation and Curriculum Design (5/15–7/3)	3	Log into Moodle on M 5/15 by 10:00 p.m.	Online	Dr. Patricia O'Brien

DOCTOR OF CLINICAL PSYCHOLOGY - Sr. Donna Kelley, Director						
50218	PSYC 697	Master's Comprehensive Examination	0		Online	Sr. Donna Kelley
50219	PSYC 702A	Professional Issues and Ethics	3	M 7:20–10:00 p.m.	Online Synchronous	Dr. Jolie Bell
50220	PSYC 702B	Professional Issues and Ethics	3	M 7:20–10:00 p.m.	Online Synchronous	Dr. Mary Tabit
50221	PSYC 705A	Human Development	3	T 4:30–7:10 p.m.	Online Synchronous	Dr. Kim Levan

GRADUATE COURSE LISTING SUMMER 2023

50222	PSYC 705B	Human Development	3	T 4:30–7:10 p.m.	Online Synchronous	Dr. Dawn Kriebel
50223	PSYC 709A	Group Dynamics	3	M 4:30–7:10 p.m.	Online Synchronous	Staff
50224	PSYC 709B	Group Dynamics	3	M 4:30–7:10 p.m.	Online Synchronous	Staff
50226	PSYC 713A	History and Systems in Psychology (5/16–6/27)	3	T, Th 7:20–10:00 p.m.	Online Synchronous	Dr. Jolie Bell
50226	PSYC 713B	History and Systems in Psychology (5/16–6/27)	3	T, Th 7:20–10:00 p.m.	Online Synchronous	Staff
50227	PSYC 731A	Assessment V: Neuropsychological	3	Th 4:30–7:10 p.m.	Online Synchronous	Dr. Julie Keaveney
50228	PSYC 731B	Assessment V: Neuropsychological	3	Th 4:30–7:10 p.m.	Online Synchronous	Dr. Julie Guay
50229	PSYC 740A	Clinical Psychopharmacology	3	M 4:30–7:10 p.m.	Online Synchronous	Staff
50230	PSYC 740A	Clinical Psychopharmacology	3	M 4:30–7:10 p.m.	Online Synchronous	Staff
50231	PSYC 741	Clinical Supervision	3	M 4:30–7:10 p.m.	Online Synchronous	Dr. Avina Khatani
50232	PSYC 797	Comprehensive Examination	0			Sr. Donna Kelley
Practicum/Seminar:						
50233	PSYC 704	Pre-Practicum Seminar*	0	As needed for students beginning their first practicum before the scheduled start date. Contact Sr. Monica Acri if you plan to register for PSYC 704		
50234	PSYC 716A	Practicum & Seminar III	3	W 4:30–7:10 p.m.	Online Synchronous	Seminar Faculty
50235	PSYC 716B	Practicum & Seminar III	3	Th 4:30–7:10 p.m.	Online Synchronous	Seminar Faculty
50236	PSYC 725A	Practicum & Seminar VI	3	W 4:30–7:10 p.m.	Online Synchronous	Seminar Faculty
50237	PSYC 725B	Practicum & Seminar VI	3	Th 4:30–7:10 p.m.	Online Synchronous	Seminar Faculty
Internship:						
	PSYC 792	Internship in Clinical Psychology V	1.5	By arrangement with Dr. Kristen Ullrich		
	PSYC 793	Internship in Clinical Psychology VI	1.5	By arrangement with Dr. Kristen Ullrich		
Internship students will receive their CRN number via Immaculata email.						
Dissertation:						
	PSYC 799	Doctoral Dissertation II	3	By arrangement with Dissertation Chair		
	PSYC 000	Dissertation Continuation	0	Open only to students have completed PSYC 798, 799 & 800. Fee equivalent to one doctoral credit: \$990 (first enrollment). Fee equivalent to three doctoral credits: \$2970 (subsequent enrollments)		
Dissertation students will receive their CNR via Immaculata email.						

NOTES: The University reserves the right to change the courses offered, enrollment caps, times, and faculty. All classes have limited enrollment. You are encouraged to register early. The College of Graduate Studies supports and encourages the use of technology as a part of the learning process.

REGISTRATION INFORMATION SUMMER 2023

GENERAL INFORMATION

The Summer 2023 registration process begins with the publication of this listing for graduate course offerings. Please refer to the “Class Meeting Dates” on page 3 for specific term dates.

REGISTRATION

Graduate students may register online using (SSIU) - Self-Service Immaculata University.

Please refer to page 11 for step-by-step instructions on how to register online.

Online registration will open at 6:00 a.m. on Monday, March 20, 2023. Please note that some course registrations must be handled through the Graduate Office. Wait lists will be managed through the Registrar’s Office. All financial obligations must be met prior to online registration and office registration.

ADVISEMENT

Your advisor will receive a copy of your course selections for review and approval and will contact you if necessary.

If you would like to meet with your advisor prior to submitting course selections, please call as soon as possible to schedule an appointment.

DROP/ADD - WITHDRAWAL - REFUND POLICY

Following the submission of either an official add/drop form or a withdrawal form (after the third session), tuition refunds for semester length courses are made on the following basis:

prior to first class.....	100%
after the first but prior to the second class.....	80%
after the second but prior to the third class.....	60%
after the third but prior to the fourth class.....	40%
after the fourth but prior to the fifth class.....	20%
after the fifth class.....	no refund

Students may add and drop classes online for Summer until May 14, 2023. After this date, you must process registration updates through the Graduate Office. If you are dropping all of your courses for a term, you must contact the Graduate Office.

- Refund policies for 7-week courses can be found at immaculata.edu/academics/registrar-s-office
- Refunds for special topics and other courses scheduled in special formats will be pro-rated.

NOT A CURRENT STUDENT? INTERESTED IN TAKING A COURSE?

Call 610-647-4400 x3005 for Application Information
gradadmission@immaculata.edu

immaculata.edu/graduate

PREPARING TO REGISTER

For New Students

1. Go to **myiu.immaculata.edu**
2. Click on the New Student Login icon or link.
3. You will be prompted to enter your username from your welcome email.
4. After you have logged into MyIU, click on the SSIU campus application.
5. Enter the verification code located on your welcome emails and follow the directions to create your password.

STUDENT FINANCIAL RESPONSIBILITY AGREEMENT (SFRA)

All students must accept the Student Financial Responsibility Agreement (SFRA) each term. The agreement defines the financial terms associated with course registration, including payment, IU email, billing, late fees, financial holds, financial aid, course add/drop/withdrawal, change of name/address/phone number and debt collection.

From SSIU, click Student, Student Financial Responsibility Agreement, and select Term. Click the Confirm Agreement button. You will then be able to move on to Look Up Classes.

LOOK UP CLASSES

The online course schedule shows the most up-to-date information about remaining seats.

- Click on Look Up Classes.
- In the Search by Term box, select a term and Submit.
- Click on the desired subject. All graduate courses start with the prefix “Grad-” (i.e. Grad-Core, Grad-EDL, Grad-Psyc).
- Click on Course Search at the bottom of the screen to view results.
- Choose the Advanced Search feature to refine your results. (You must select at least one Subject.)

Closed sections will have a “C” in the Select column. Please call the Registrar’s Office if you wish to be placed on a wait list.

ADD CLASSES

- Select a section by clicking on the checkbox and clicking the Register button. You can see the class you added in the Current Schedule listing.
- Classes that cannot be added successfully will appear under Registration Add Errors. Click on the Submit Changes button to clear the errors.
- To select alternate courses or sections, click on Class Search to return to the Look Up Classes screen and repeat the process.

Another way to add courses is to Return to Menu after you review the courses on Look Up Classes.

- Click on Add or Drop Classes.
- Enter the CRNs in the boxes under Add Classes Worksheet.
- Click Submit Changes.

DROP CLASSES

- Click on Add or Drop Classes.
- Select “Web Drop” from the Action pull-down list on the left.
- Click Submit Changes.

PRINT YOUR SCHEDULE

For New Students

Return to Menu, and select Student Detail Schedule to view and print your schedule. The One Card office requires you to bring your printed schedule to obtain a student ID Card.

ACCESS MY FINAL GRADE

Final grades are posted on SSIU after the conclusion of your course. Visit Student, Student Records, Final Grades, and Select a Term and Submit.

REGISTRATION INFORMATION SUMMER 2023

ONLINE REGISTRATION RESTRICTIONS/NOTES

Prerequisites

If you have not completed the appropriate prerequisite for a course, you will get an error. Please contact the Graduate Office for assistance.

Repeats

Take care not to register for a course that you have already taken. If you are required to repeat a course in order to achieve a higher grade, please contact the Graduate Office for assistance.

Leave of Absence

If you are on a leave of absence and want to return, please notify the Graduate Office, and we will change your status to Active student to allow you to register.

Independent Projects

All students studying an independent project must complete and submit the "Independent Project" form, which is available in the Graduate Office.

Dissertations

Doctoral students studying Dissertation I, II, III or continuous, will receive an email with the CRN number for their section of dissertation so that they can register online.

Doctoral Internships

Doctoral students on internship will receive their CRN number(s) via email from the Graduate Office. If you need internship registration assistance, please call 610-647-4400, Ext. 3246.

Offsite/Cohort Students

Offsite sections (CRNs) are not listed in this publication. You will receive registration instructions from the Special Programs Department.

Holds

You will be required to clear any financial or other holds on your account prior to registering online or through the Graduate Office.

If you have any questions about registration, please contact the College of Graduate Studies office at 610-647-4400 x3215. We will be glad to assist you with your registration.

For technical support, please submit a ticket to the IU Support Center by clicking on that campus application in MyIU, and provide a brief description of your question or issue.

EXPENSES AND PAYMENT INFORMATION

Tuition, Charges and Fees (2022–2023)

Management and Leadership Course Fee.....	\$95
PSY Exam/EPPP.....	\$1099

Tuition (per credit)

Master's Courses.....	\$710 per credit
Doctoral Ed.D. Courses.....	\$955 per credit
Doctoral Psy.D. Courses.....	\$990 per credit

Comprehensive Examination Fee

Master's.....	\$150
Doctoral.....	\$160

Practicum and Internship Fees (per semester)

Student Teaching.....	\$350
Music Therapy.....	\$50/\$100
Nursing.....	\$110
Dietetic Internship.....	\$260
Psychology Field Site.....	\$250

General Fees

Graduation Fee.....	\$150
Late Payment Fee.....	\$30
Returned Check Charge.....	\$30

PAYMENT INFORMATION

Tuition and fees are due in full by April 21, 2023 to avoid late fees and account holds. For additional information regarding billing and payment policies, please see below.

Contact studentaccounts@immaculata.edu or 610-647-4400, ext. 3174 with any payment questions.

How to make a payment:

- Online at MYIU STUDENT ACCOUNT CENTER. Select MAKE PAYMENT tab at top. Credit card and check payments are accepted.
- By mail, make check payable to Immaculata University and mail to: Business Office, Villa Maria #14, Immaculata, PA 19345.
- In person at the Business Office located in Room #14 in the terrace level of Villa Maria Hall. A payment drop box is located in the hallway if the office is closed.

BILLING AND PAYMENT POLICY

Tuition and fees are due to be paid in full by April 21, 2023. Initial term bill will be generated electronically and in paper beginning April 4, 2023. If registering after

April 21, 2023, make payment at time of registration. Subsequent monthly billing statements will be available only electronically through SSIU.

To avoid account holds and monthly late fees of \$30 be sure to make your payment on time. All financial aid recipients must ensure their financial aid is available by April 4, 2023.

Once registered, a student assumes financial responsibility for charges (see SFRA). Students with outstanding financial obligations are not permitted to attend class, occupy University Housing, and receive grades, teacher certification transcripts or diplomas. Immaculata reserves the right to assign outstanding balances to collection agencies.

Students who are reimbursed by employers may obtain a course enrollment document that includes course information, grade and cost. This document is available online at SSIU, accessible through MyIU.

The CAPS and Graduate Student Course Reimbursement form is available to view and print from the Student menu. This form summarizes course-related charges and grades by term and can be used for reimbursement.

IU INSTALLMENT PAYMENT PLAN

You may choose to enroll in the IU Installment Payment Plan which distributes payment across 3 due dates within the term. Enrollment forms are available online through MyIU under Resources, Student Finances. There is a \$25 non-refundable installment plan enrollment fee that is due immediately; this fee is not included as part of the installment payment plan. To avoid account holds and a monthly late fee of \$30, please remit payment at time of enrollment. For your convenience payments are accepted online through Self Service IU (SSIU).

Installment payments due: April 21, 2023 | May 21, 2023 | June 20, 2023

CAMPUS MAP

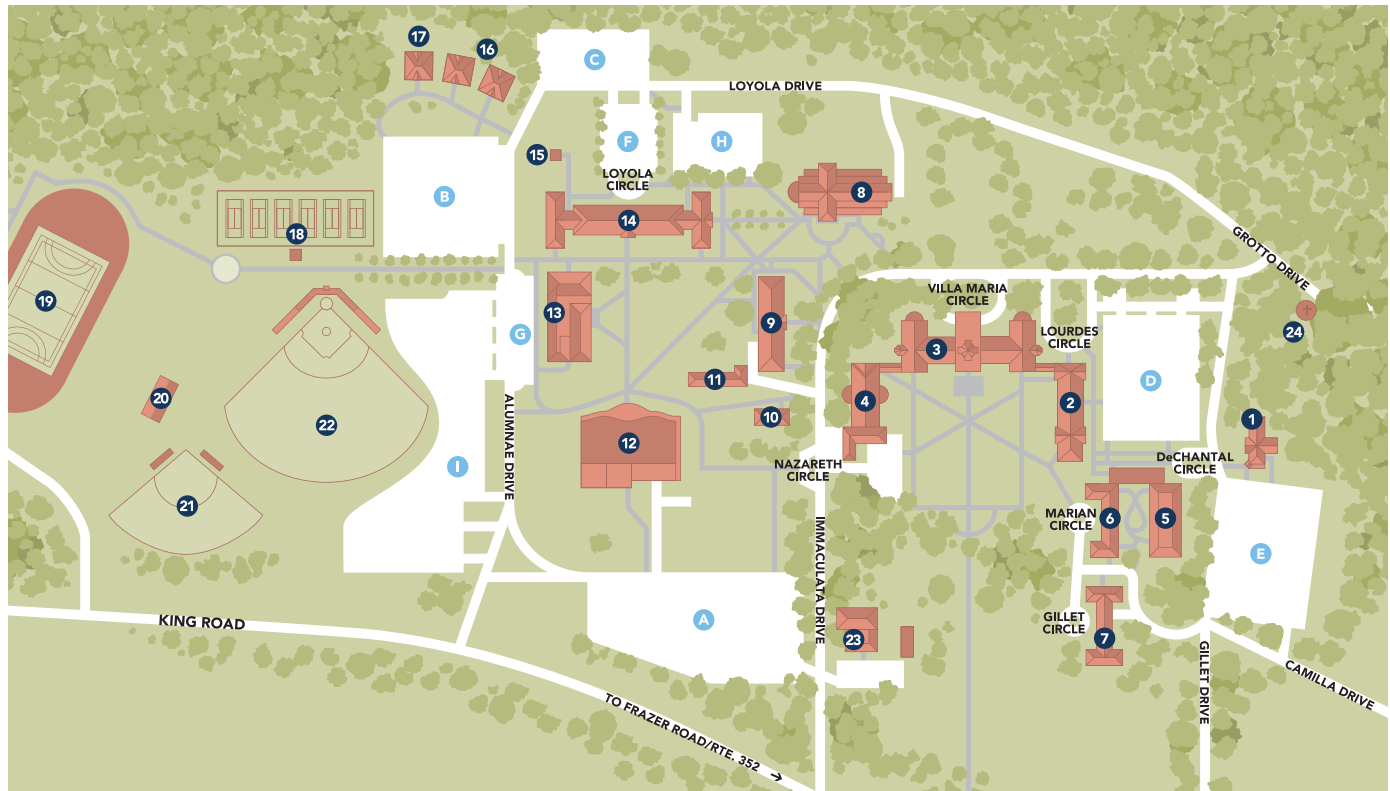

- | | | |
|-------------------------------|------------------------------|-----------------------------------|
| 1. Lillian P. Lettiere Center | 10. Mary A. Bruder Center | 19. Draper Walsh Stadium |
| 2. Lourdes Hall | 11. Faculty Ccenter | 20. Mighty Macs Training Facility |
| 3. Villa Maria Hall | 12. Alumnae Hall | 21. Softball Field |
| 4. Nazareth Hall | 13. Parsons Science Pavilion | 22. Baseball Field |
| 5. DeChantal Residence Hall | 14. Loyola Hall | 23. Power House |
| 6. Marian Residence Hall | 15. McIntyre Greenhouse | 24. Lourdes Grotto |
| 7. Gillet Hall | 16. West Campus Housing | A–I. Parking |
| 8. Gabriele Library | 17. IHM Student Center | |
| 9. Good Counsel Hall | 18. Tennis Courts | |

DIRECTIONS TO CAMPUS

immaculata.edu/about/maps-and-directions



IMMACULATA UNIVERSITY

1145 West King Road
Immaculata, PA 19345

immaculata.edu/graduate